

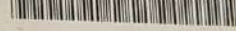

Keloc PC, spol. s r.o.
 Náměstí SNP 32
 614 00 Brno
 tel: 545 426 911
 www.keloc.cz

2547

PROD CODE:SR2800URLX



SERIAL NO:8ZDT93000177



TA NO:E43324-005

This device complies with Part 15 of the FCC Rules. Operation of this device is subject to the following two conditions:
 (1) This device may not cause harmful interference, and
 (2) This device must accept any interference received, including interference that may cause undesired operation.

CANADA ICES-003 CLASS A Intel Corporation
 この装置は、クラスA情報技術機器です。この装置を家庭環境で使用すると電波妨害を引き起こすことがあります。この場合には使用者が適切な対策を講ずるよう要求されることがあります。 VCCI-A

警告使用者:
 這是甲類的資訊產品，在居住的環境中使用時，可能會造成射頻干擾，在這種情況下，使用者會被要求採取某些適當的對策。

声明
 此为A级产品，在生活环境中，该产品可能会造成无线电干扰，在这种情况下，可能需要用户对干扰采取可行的措施。



100-127/200-240Vac ~
 50/60Hz
 7.3.5 A

인증번호: CPU-
 SR2800(A)

181080057301

SR2600

服务器 MADE IN CHINA 中国制造 IPT

010452



S51a	TP1	BI	TP2	S	T2	IC	C	B
S51n		0	2	S	S	T2	3	2

33022400 00

 台达电子工业股份有限公司
DELTA ELECTRONICS, INC.

SWITCHING POWER SUPPLY CM-1
 开关电源

MODEL (型号): AC-075 A REV (版本): 01F
 INPUT MUST MATE WITH POWER MODULE DPS-750PB A
 (输入必须配合开关电源 DPS-750PB A)

OUTPUT: 725W MAX. (最大输出 725W)

+5VSB	=== / 3.0A	+12V1	=== / 24.0A
+3.3V	=== / 24.0A	+12V2	=== / 24.0A
+5V	=== / 30.0A	+12V3	=== / 16.0A
-12V	=== / 0.5A	+12V4	=== / 16.0A

3.3V & 5V COMBINED POWER 170W MAX.
 (3.3V 和 5V 合并最大输出 170W)

THE MAX IS 48A FOR COMBINED +12V
 (12V 合并最大输出 48A)

P/N 
 E30694-007

S/N 
 E30694D0924009982

MADE IN CHINA. (DCGP) (制造地: 中国东莞)

 92429FS01915057
 6070B0242903 A01

6070B0242903 A01
92429FS01915057



MADE IN CHINA.(DCGP) (制造地:中国东莞)
E30694D0924009982



S/N

E30694-007



P/N

(3.3V)
THE MAX IS 48A FOR COMB
(12V 含并最大输出 48A)

6055B0379701 A01

8021803508 05

11330
>66<

V01

WARNING: READ THE USER MANUAL BEFORE USING THIS PRODUCT.
DANGER: HIGH VOLTAGE!
DO NOT TOUCH THE INTERNAL COMPONENTS.
© 2008 DELL CORPORATION

DELL
PART NUMBER: PA1 11264 - 010

PRIMAAL 3722



USB FLOPPY

2

C2A1
C2A2

OPTICAL DRIVE INTERPOSER

SN:VG97BP0398 R

E2UE92905929 PBA E26739-102

SATA ODD I/F S/A



Chassis Quick Reference

IMPORTANT NOTE: Please read all Warnings and Cautions before servicing this system!

A Major Server System Components

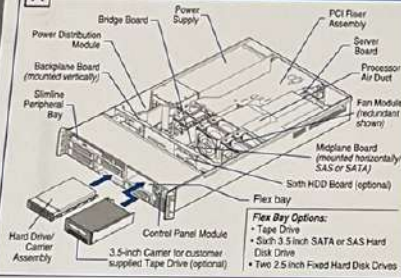

B Replacing the Bridge Board



C PCI Add-in Card Riser Assembly Removal/Installation

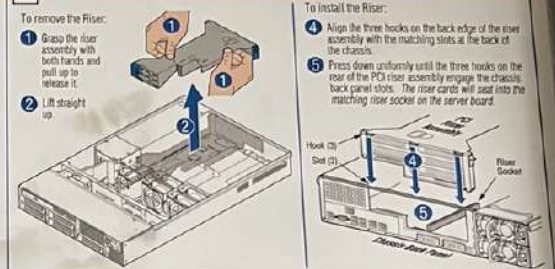

D SATA Midplane Diagram



SAS Midplane & Backplane Diagram

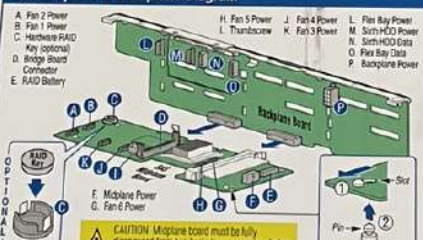

E Fan Replacement-Redundant

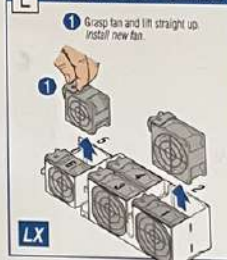

F Fan Replacement-Nonredundant

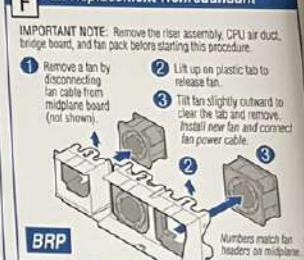

Server Board Configuration Diagram

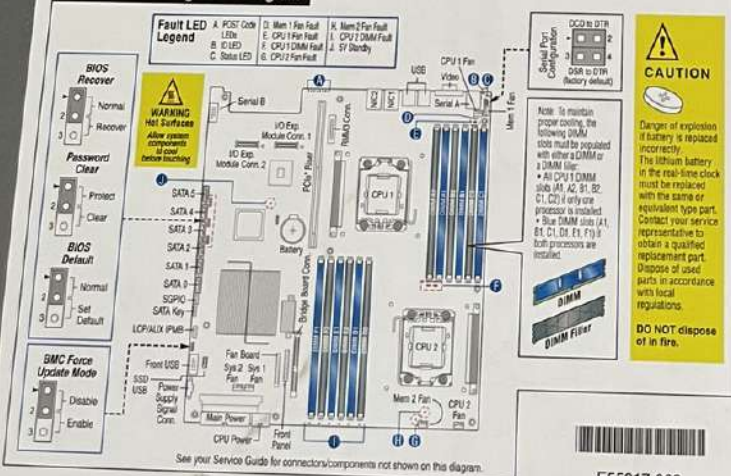

G System Cabling Diagram/Component Reference



H Installing DIMMs

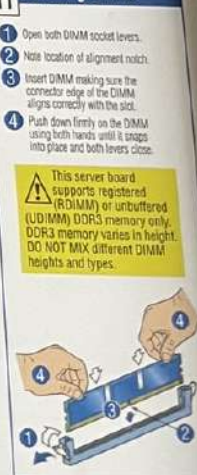

E55217-002



PROD. CODE: SR2400SYS



SERIAL NO.: BZDR51356824



TA NO.: C51956-003

This device complies with Part 15 of the FCC Rules. Operation of this device is subject to the following two conditions:

- (1) This device may not cause harmful interference, and
- (2) This device must accept any interference received, including interference that may cause undesired operation.

CANADA ICES-003 CLASS A

Intel Corporation

この装置は、クラスA 情報技術装置です。この装置を家庭環境で使用すると電波妨害を引き起こすことがあります。この場合には使用者が適切な対策を講ずるよう要求されることがあります。VCCI-A

警告使用者:

這是甲類的資訊產品，在居住的環境中使用時，可能會造成射頻干擾，在這種情況下，使用者會被要求採取某些適當的對策。

声明

此为A级产品，在生活环境中，该产品可能会造成无线电干扰。在这种情况下，可能需要用户对干扰采取可行的措施。



LISTED
ITE
E139761
US

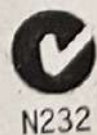

100-127/200-240V,
50/60Hz,
7.0/3.5A
SR2400

181A70110404
C79932-002

6060A0275201

服务器 MADE IN CHINA 中国制造 CM-2

©2004 Microsoft Corporation
Certificate of Authenticity

**Win SBS Prem 2003 1-2CPU 5-CAL
OEM Software**

Product Key: XJKYV - 69KQF - MW97J - KYPTP - 2Y3HQ



00085-129-788-968

Outlook® 2003/FrontPage® 2003

Product Key: XBVJD - YCCYR - 7DF28 - JH2PX - MYT7M

www.microsoft.com/piracy/howtotell



X10-37281



Tento Certifikát pravosti jste
povinni připevnit k vnější
straně skříně počítače.

Win SBS Prem 2003 1-2CPU 5-CAL

00085-129-788-968



声明

此为A级产品，在生活环境中，该产品可能会造成无线电干扰。在这种情况下，可能需要用户对其干扰采取切实可行的措施。



台达电子工业股份有限公司
DELTA ELECTRONICS, INC.

MODEL(型号): AC-025 A REV(版本): 03

INPUT MUST MATE WITH POWER MODULE DPS-700EB A

(输入必需配合电源供应器 DPS-700EB A)

OUTPUT(输出): 700W MAX.

+5Vsb / 2.0A, +12V1 / 12.5A,
+3.3V / 24.0A, +12V2 / 12.5A,
+5V / 24.0A, +12V3 / 14.0A,
-12V / 0.5A, +12V4 / 14.0A,

3.3V/5V COMBINED POWER 140W MAX.

(3.3V 与 5V 合併 最大输出 140W)

THE MAX IS 48A FOR COMBINED +12V.

(+12V 合併 最大输出电流 48A)

P/N:



C41626-008

S/N:



DLD0508004982

MADE IN CHINA.(DCGP) (制造地: 中国东莞)

CM-1



N193



D33030



A000119



CE, FCC, RoHS, and other regulatory compliance logos and text.

Barcode label on a drive tray.

Barcode label on a drive tray.

CAUTION: HIGH VOLTAGE
CAUTION: HIGH VOLTAGE
CAUTION: HIGH VOLTAGE
CAUTION: HIGH VOLTAGE
CAUTION: HIGH VOLTAGE
CAUTION: HIGH VOLTAGE

CAUTION: HIGH VOLTAGE
CAUTION: HIGH VOLTAGE

声明
此为A级产品，在生活环境中，
该产品可能会造成无线电干扰。
在这种情况下，可能需要用户
对其干扰采取切实可行的措施。

DELTA ELECTRONICS, INC.
MODEL: AC-235 A REV: 000 1.03
INPUT: 115V/230V 50/60Hz
OUTPUT: +5V 2.0A, +12V 1.0A, +5V 1.0A, +12V 1.0A, +5V 1.0A, +12V 1.0A, +5V 1.0A, +12V 1.0A
MADE IN CHINA (COCYF) (08-08-08)

MS7501
MS7501

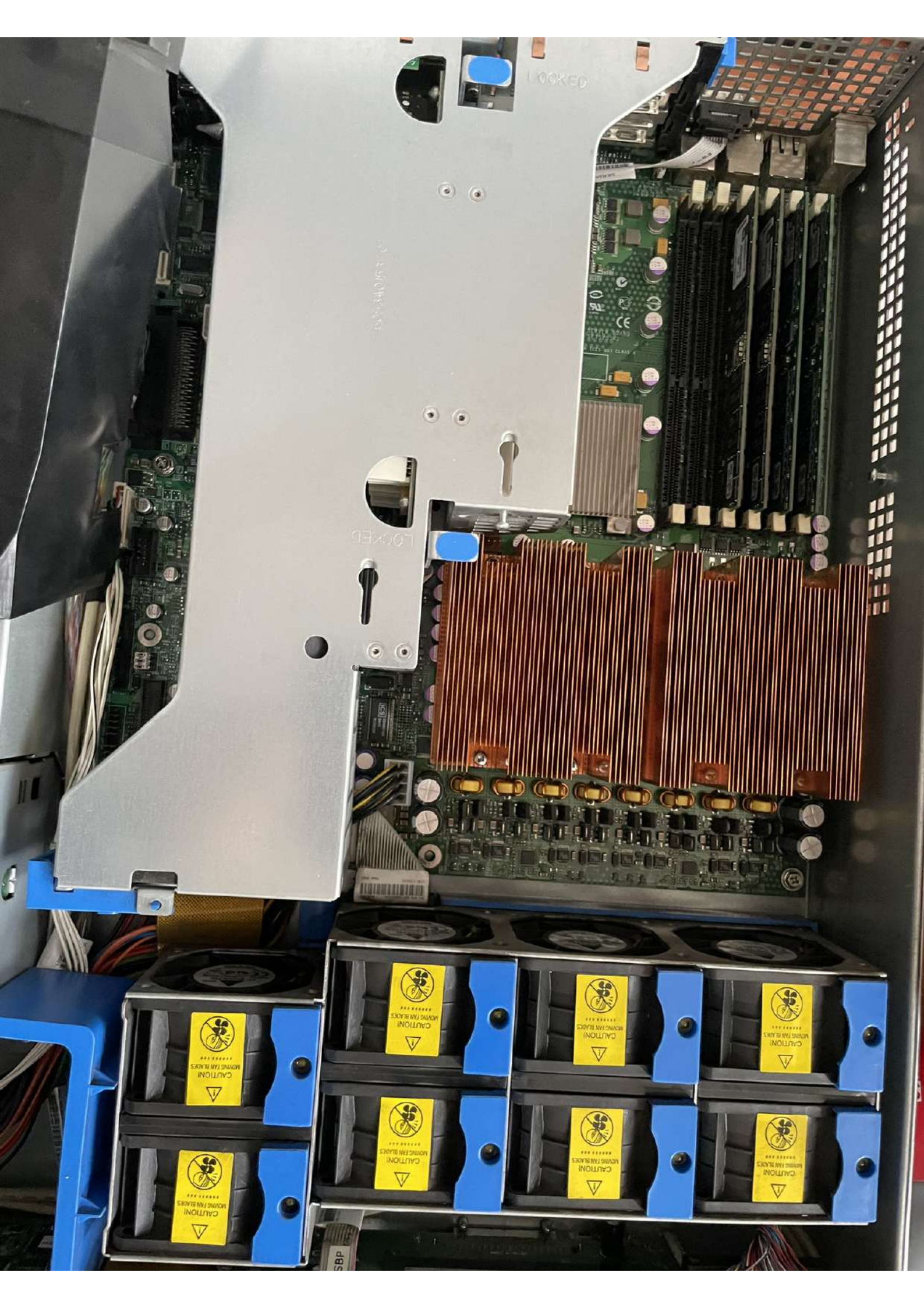

LOCKED

LOCKED

CAUTION!
MOVING FAN BLADES

CAUTION!
MOVING FAN BLADES

CAUTION!
MOVING FAN BLADES

CAUTION!
MOVING FAN BLADES

CAUTION!
MOVING FAN BLADES

CAUTION!
MOVING FAN BLADES

CAUTION!
MOVING FAN BLADES

CAUTION!
MOVING FAN BLADES

SBP





Mikrotik
RouterBOARD

- Wi-Fi
- 1
- 2
- 3
- 4
- 5

RB951G-2HnD

FCC ID: TV7RB951G-2HND
E4:8D:8C:AA:C5:89

E4:8D:8C:AA:C5:8E



SN: 642E052632DA/615



MikroTik

This device complies with Part 15 of the FCC Rules. Operation is subject to the following two conditions: 1) this device may not cause harmful interference, and 2) this device must accept any interference received, including interference that may cause undesired operation.

